

**MODEL 381 BARREL PUMP**

(For 15-55 gallon drums with 1 1/2" or 2" opening)

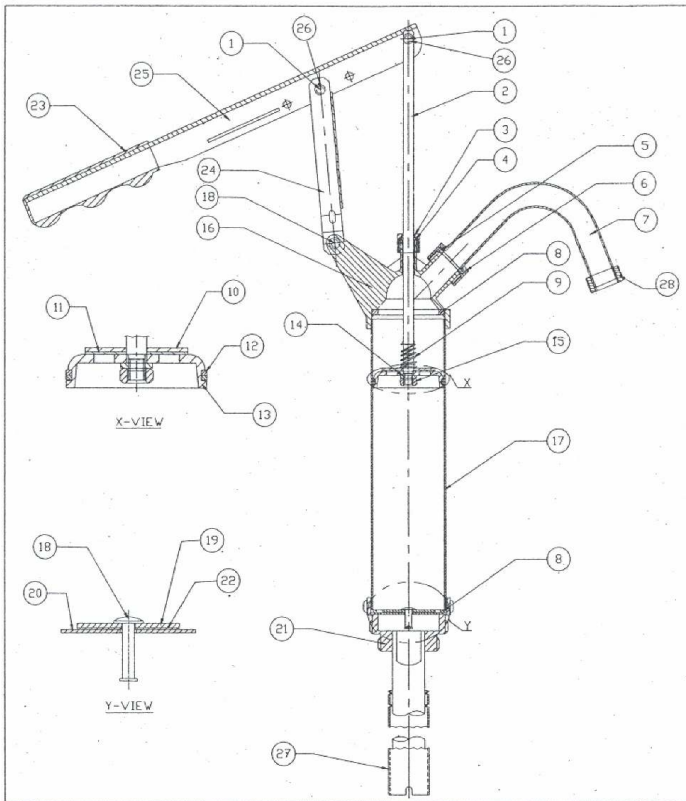

Sr Nr	Part Name	Qty
1	Rivet	2
2	Piston Rod	1
3	Hex Nut	1
4	O-Ring	1
5	Rubber Washer	1
6	Hex Nut	1
7	Discharge Spout	1
8	Rubber Washer	2
9	Taper Spring	1
10	Steel Washer	1
11	Rubber Washer	1
12	Brass Piston Ring	2
13	Piston Ring Holder	1
14	Spring Washer	1
15	Hex Nut	1
16	Pump Head	1
17	Barrel	1
18	Rivet	2
19	Steel Washer	1
20	Steel Washer 7 Holes	1
21	Bung Nut	1
22	Rubber Washer	1
23	Rubber Grip	1
24	Connecting Link	1
25	Lever Handle	1
26	Cotter Pin	2
27	Telescopic Suction Tube	1
28	3/4" Nut	1

NOTE: Units have standard garden hose threads

**ASSEMBLY INSTRUCTIONS:**

1. Remove rivet (1) from piston rod (2).
2. Line up holes in lever handle (25) to piston rod (2) and insert rivet (1), and then insert cotter pin (26).
3. Screw telescopic suction tube (27) into threaded bung nut (21) at base of pump.
4. Insert pump assembly in drum bung and tighten the bung nut (21) till all the threads are screwed. The pump should be tightened by holding the pump barrel. Never tighten the pump by rotating the lever handle (25).
5. Screw on the discharge spout (7) onto the pump head (16), using the hex net (6). Ensure that the rubber washer (5) is in place while doing so.
6. In using the pump the first time, it maybe necessary to prime it by putting some of the liquid, which is to be pumped, into the nozzle.
7. Depending upon the viscosity of liquid being pumped, the link (24) connecting the pump head (16) to the lever handle (25) may be adjusted for enhanced convenience in operation. The connecting link (24) is connected to the lever handle (25) through rivet (1) and cotter pin (26) and can be positioned in either of the 3 holes in the lever handle. Choose the middle hold with liquids of medium viscosity, the lower hole towards the rubber handle for pumping low viscosity liquids and the top hole for highly viscous media.

**NOTE: This pump is made from steel, brass and nitrile rubber and should not be used with fluids affecting these materials. Pumps, which have been used with corrosive material, DO NOT qualify for warranty adjustment.**