

Item Number	Description	Weight (lbs)
918S--1000 AA	Single channel tank alarm box only	1.13
918D--1000 AA	Dual channel tank alarm box only	1.40
918Q--1000 AA	Quad channel tank alarm box only	1.40
918---0100 AG	2" Clock gauge single tank alarm with standard float	6.30
918---0400 AG	2" Clock gauge single tank alarm with drop tube float	6.30
918C--0100 AG	2" Gallon gauge single tank alarm with standard float *	6.30
918C--0400 AG	2" Gallon gauge single tank alarm with drop tube float *	6.30
918CF-0100 AG	2" Gallon gauge single tank alarm, female thread with standard float *	6.30
918CF-0400 AG	2" Gallon gauge single tank alarm, female thread with drop tube float *	6.30
918F--0100 AG	2" Clock gauge single tank alarm, female thread with standard float	6.30
918F--0400 AG	2" Clock gauge single tank alarm, female thread with drop tube float	6.30
918---0000 AG	2" Clock gauge less alarm, standard float, male threads	6.20
918---0000AGEVR	2" Clock gauge less alarm, standard float, male threads, EVR	6.20
918---2000 AG	2" Clock gauge less alarm, drop tube float, male threads	6.20
918---2000AGEVR	2" Clock gauge less alarm, drop tube float, male threads, EVR	6.20
918C--0000 AG	2" Gallon gauge less alarm, standard float, male threads	6.20
918C--2000 AG	2" Gallon gauge less alarm, drop tube float, male threads	6.20
918CF-0000 AG	2" Gallon gauge less alarm, standard float, female threads	6.20
918CF-2000 AG	2" Gallon gauge less alarm, drop tube float, female threads	6.20
918F--0000AGEVR	2" Clock gauge less alarm, standard float, female threads, EVR	6.20
918F--2000AGEVR	2" Clock gauge less alarm, drop tube float, female threads, EVR	6.20
918TCP0400 AS	2" Sensor assembly set at 5 feet	4.60
918TCP0500 AS	2" Sensor assembly set at 9.5 feet	4.60
918TCPS400 AS	2" Sensor assembly set at 5' with SS male thread adaptor & QD top	6.60
918TCPS500 AS	2" Sensor assembly set at 9.5' with SS male thread adaptor & QD top	6.60
918TCPS800 AS	2" Sensor assembly set at 5' with SS female thread adaptor & QD top	6.40
918TCPS900 AS	2" Sensor assembly set at 9.5' with SS female thread adaptor & QD top	6.40

Tank Alarms

Clock Gauge Tank Alarm Kits

Clock Gauges

Sensor Assemblies

\*Indicates a clock face must be ordered with this item.  
Consult Price List for complete list including metric and BSP threaded options.



# 918 Clock Gauge & Tank Alarm



Morrison is expanding our tank alarm offerings! In addition to an updated single alarm box, we now offer **dual (D)** and **quad (Q)** alarm boxes.

**Features**

- ◆ Audible and visual indicators
- ◆ Self-powered by long-life replaceable lithium batteries
- ◆ Monitor up to four sensor signals
- ◆ User-defined alarm labels
- ◆ Visual alarm indicators easily identify which sensor is alarming
- ◆ Compatible with 918/918 TCP gauging equipment
- ◆ Low battery visual indicator
- ◆ Audible alarm sounds 90 dB alarm at four feet away
- ◆ Modular contacts make alarm devices easy to install
- ◆ In compliance with UL 913 and CSA 157 intrinsic safety standards
- ◆ Corrosion-resistant and water-resistant housing for long life
- ◆ Intrinsically safe for Class I, Division 1 and 2, Group D hazardous location

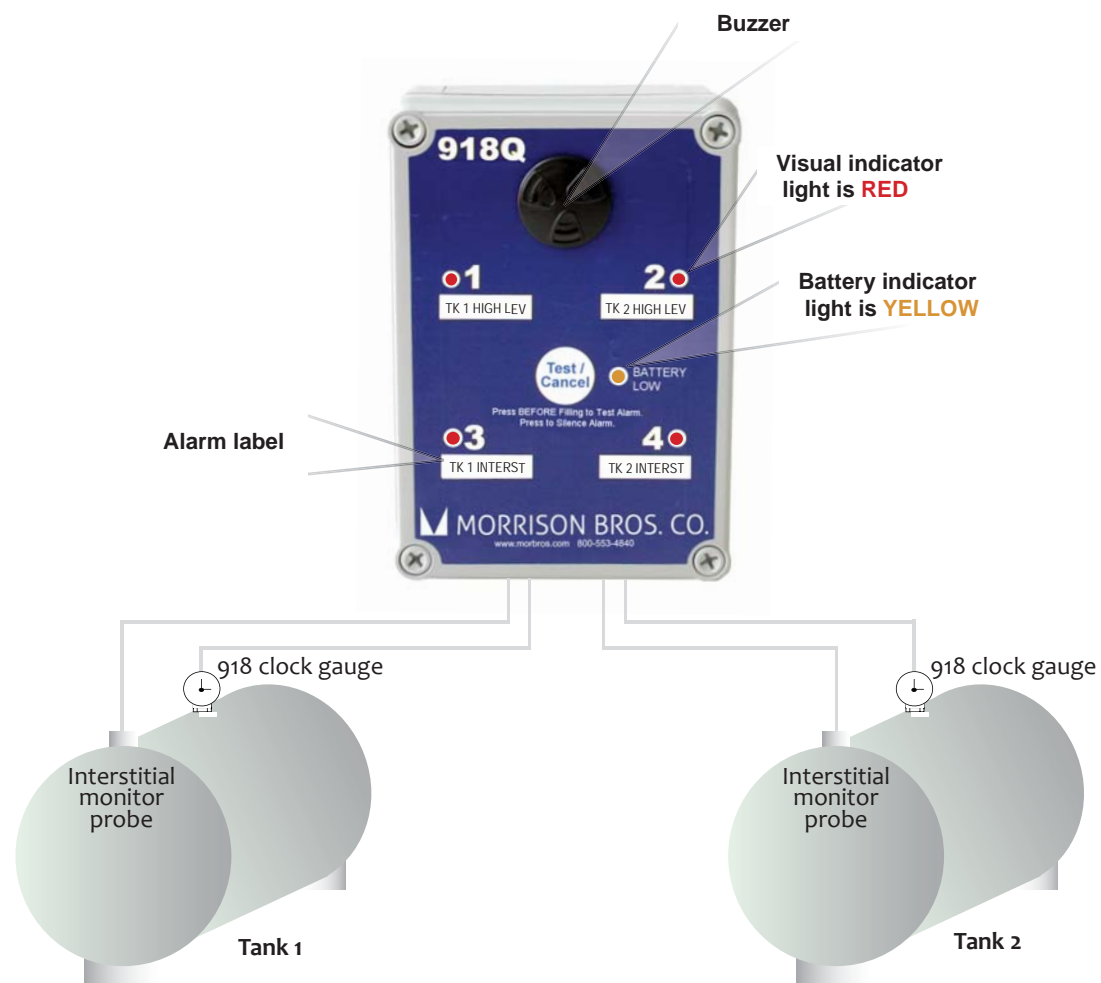

**Morrison makes it easy to customize your alarm system!**



Connect **1** ...



... or **2** ...



... or **4** alarm devices!

