

SUBMITTAL DATA SHEET

Waste Water Effluent | Sewage Ejectors | Grinders Sewage Ejector - 4/10 HP

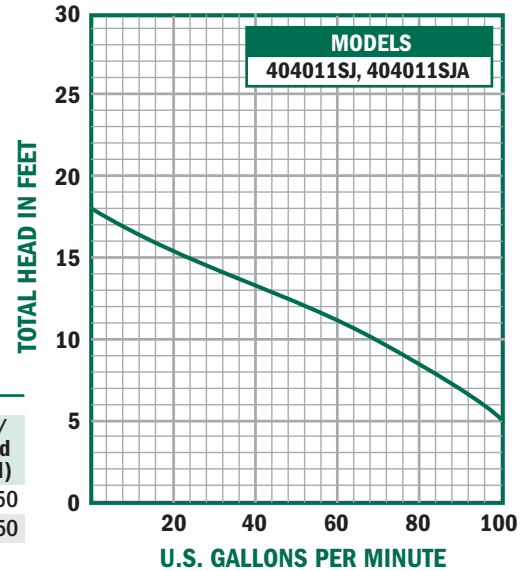

Rugged, cast iron housing for residential and light commercial wastewater applications. Stainless steel fasteners and motor shaft, also available with or without piggyback float switch.

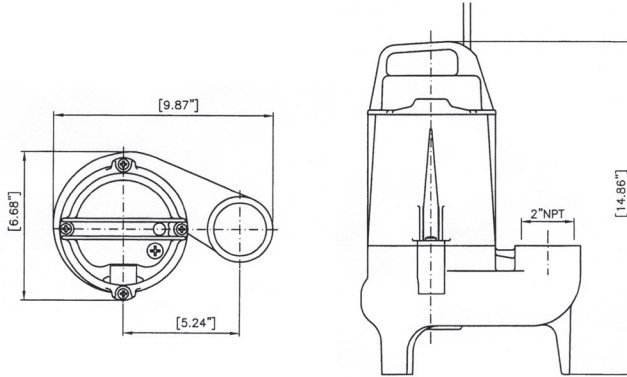

Motor Data, 60 Hz

Model Number	Phase	Rated Output Power	Volts	Full Load Amps	Locked Rotor Amps	NEMA Code Letter	Power Factor 100% Load	Motor Efficiency 100% Load	Pole/Speed (RPM)
404011SJ	1	0.4 HP	115	6.6	17.7	F	0.92	57	4/1750
404011SJA	1	0.4 HP	115	6.6	17.7	F	0.92	57	4/1750

Materials of Construction & Motor Specifications

Motor Housing	Cast Iron ASTM A48 Class 30	Impeller	Polybutylene Terephthalate (PBT) 30% glass fiber, Vortex
Volute	Cast Iron ASTM A48 Class 30	Motor Design	NEMA design B, squirrel cage induction, oil filled (non toxic)
External Hardware	304 Stainless Steel	Motor Type	Enclosed submersible
O-ring	Buna-N	Insulation Class	Class B, rated at 248° F(120° C)
Motor Shaft	420 Stainless	Motor Protection	Integral Bi-Metallic current sensing switch providing over temperature shut down
Oil	Non-toxic white mineral oil (Marcol 52)	Service Factor	1.10
Upper Bearing	Single row ball bearing	Voltage Tolerance	± 10% from nominal
Lower Bearing	Single row ball bearing		
Lower Shaft Seal	Spring loaded rotating carbon face w/ stationary ceramic face		

Sewage Ejector & Cable Specifications

Model Number	Voltage	HP	Phase	Solids Size	Hertz	Speed (RPM)	Discharge	Weight	Cable Length(ft.)	Float Included	Outer Jacket
404011SJ	115	4/10	1	2"	60	1750	2" Vert NPT	35	15	N	Thermoplastic elastomer
404011SJA	115	4/10	1	2"	60	1750	2" Vert NPT	37	15	Y	Thermoplastic elastomer

- Power Cable - 16/3 SJTOW-A or equiv. w/ 3 prong plug
- Maximum submergence (feet) = 30
- Maximum temp. of pumped fluid = 104° F(40°C) continuous, =122°F (50°C) intermittent

SUBMITTAL INFORMATION

- High torque capacitor start motors
- Upper & lower ball bearings
- 2" NPT vertical discharge, vortex impellers
- Oil-filled motors (non-toxic oil)
- Integrated clip for float switch cable

NO-LEAD: The weighted average of the wetted surface of this no-lead product contacted by consumable water contains less than one quarter of one percent (0.25%) lead.



A.Y. McDonald Mfg. Co.
P.O. Box 508
Dubuque, IA 52004-0508

Toll Free: 1-800-292-2737
Fax: 1-800-832-9296
Hours: 7:00 a.m. - 5:00 p.m., CST

sales@aymcdonald.com
www.aymcdonald.com

A.Y. McDonald considers the information on this assembly drawing correct when published. Item and option availability, including specifications, are subject to change without notice.

Submitted by: