

Materials

Body and Adaptor Shaft: Stainless steel
Internal Components: Stainless steel
Seals: Specially formulated polymers and elastomers specific to high pressure NGV applications.

CL50



Features

- ◆ **Durable, Corrosion-Resistant Construction** - stainless steel construction provides improved durability and corrosion resistance in the harsh on-highway, heavy-duty environment. This material is harder than the original brass for even greater wear resistance and longer life.
- ◆ **Non-Contact Check Valve** - each OPW CL series receptacle contains a highly reliable non-contact check valve that opens when differential pressure is present during refueling.
- ◆ **Improved Sealing System** - the sealing system in all CL series receptacles consists of a stainless steel poppet that aligns with a rearward facing captured seal located in the receptacle body. This arrangement prevents seal “wash out” during high flow deformation and has exceptional wear resistance under all operating pressure and temperature conditions.

- ◆ **High Flow** - the flow path has been redesigned to increase the amount of flow and decrease the pressure drop resulting in a reduction of noise/vibration from the check valve during the “end of fill.”
- ◆ **Rubber Dust Cap** - a standard protective dust cap is supplied with CL50 series receptacles.
- ◆ **Serviceable O-Ring** - designed to prevent leakage at the connection point.
- ◆ **Individually Leak Tested and Inspected**

Specifications:

Min. Flow Rate: 5000 SCFM @ 3000 psid
 Temperature Range: -40° F to 250° F
 (-40° C to 120° C)

Cv: 3.30

Design Pressure: 5000 psi (345 Bar)

OPW CL50 Series Bus/Heavy-Duty Truck Receptacles

OPW now adds stainless steel receptacles to their line of heavy-duty refueling receptacles. The new CL50 Series design is the result of many years of experience in the demanding NGV environment.

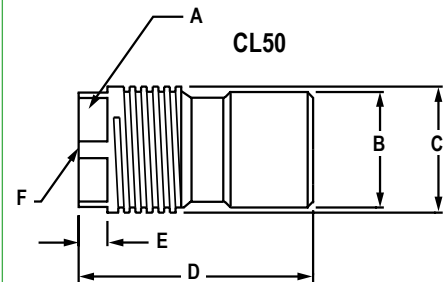

Dimensions

	CL50	
	in	mm
A	1.25	38.1
B	1.25	32
C	1.39	35
D	2.67*	68*
E	0.31	8
F	SAEJ1926-10 7/8-14 UNF	

*D-Dimensions for:

	in	mm
CL5000	4.80	122.1
CL5016	4.96	126.1
CL5078	3.76	95.6

Ordering Specifications

Product No.	Type/Size	Max. Allowable Service Pressure	Weight
CL50	7/8" - 14 SAE-10 Female Port	3600 psi (248 Bar)	0.91 lb. 0.410 kg
CL5000	5/8" Double Ferrule Fitting	3600 psi (248 Bar)	1.29 lbs. 0.587 kg
CL5078	7/8" - 14 SAE-10 Male O-Ring Fitting	3600 psi (248 Bar)	1.141 lbs. 0.520 kg
CL5016	16mm Double Ferrule Fitting	3600 psi (248 Bar)	1.29 lbs. 0.587 kg
• Connects to the CT5000S and CC6000 Series Heavy-Duty CNG Nozzles			
1121	Replacement "Interface" O-Ring for CL50 Series Receptacles		

Listings and Certifications



CE 0036

