

6SHFLILFDWLRQDWD

6ROLGVDGOLD
(OHFWULFORWRUULYHQ

6HF

3\$

- \$85<



APPROVED
XPROOF MOTORS FOR CLASS I,
DIV. 1, GROUPS C&D LOCATIONS
(X Proof Version Only)



C/US
2UGLDU\X
/RFDWLRQonly

6XEPHUVLEOH3XPS
ORGHOV

(TXSSHG LWK

6) 6HULHV

95,286 3\$(176 33<

6)6& % 6)6& %;

6LH

The Gorman Rupp SF Series pumps provide superior pumping efficiency while maintaining a _____ inch (_____ mm) spherical solids passage.

.H\) HDWØHV

Replaceable self cleaning wear plate

NEMA premium efficiency motors

Externally adjustable face clearance

Press fit motor with finned motor housing provides superior motor cooling, even in a submersed state, resulting in increased motor life

NEMA Class H motor insulation

Easy, in the field cable changes

Standard moisture detection in both the seal and motor chambers

Factory Mutual (FM) Approved for &ODVV, LLYVLRQ Group C and D Haz Loc Applications (X Proof Model)

CSA C/US Approved for 2UGLDU\X RFDWLRQDWD (6WDGDU\ model)

2SWLRQD \$FHVVVRULHV

Control Panel (Consult [SF Series Motor Data Reference](#) for Customer Supplied Control Panel)

Submersible Transducer or Ball Type Float Switches

Slide Rail Installation Components

Guide shoe w/Rubber Seal

Base Elbow and Rail Brackets

Trash Stand Installation Components

Trash Stand

Discharge Elbow

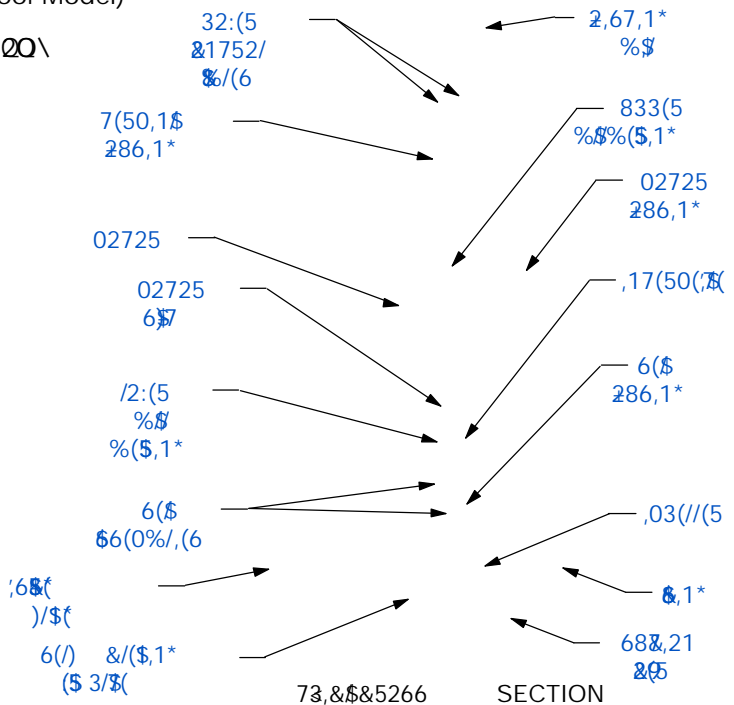

SECTION



GORMAN RUPP PUMPS

www.grpumps.com

Specifications Subject to Change Without Notice

Printed in U.S.A.

PUMP DETAILS

Pump Models	SFSC4B/SFSC4B-X		
Agency Approvals	Consult Factory		
Discharge Flange	4" ANSI w/ Flat Face		
Impeller Type / Material	Semi-Open Type, Continuous Vane Impeller / Hard Iron		
Self Cleaning Wear Plate	Hardened Alloy Steel		
Spherical Solids Handling	2.25" (57,1 mm) Non-Deformable Diameter		
Motor Housing (Including Seal Plate and Intermediate)	Gray Iron 30		
Pump Casing	Ductile Iron		
Motor Shaft/Shaft Sleeve	17- 4 PH Stainless Steel		
O-Rings	Buna-N and Fluorocarbon (DuPont Viton® or Equivalent)		
Bearings: Type/Lubrication	Upper	Single Row Ball/Permanent Lubrication	
	Lower	Double Row Ball/Permanent Lubrication	
External Hardware	303/304 Stainless Steel		
External Surface Protection	Epoxy Paint		
Seal Type	Tandem, Mechanical, Oil Lubricated Upper, Self-Lubricated Lower		
Sealing Faces: Rotating/Stationary	Upper	Carbon/Ceramic	
	Lower	Silicon Carbide/Silicon Carbide	
Seal Elastomers	Buna-N Upper, Fluorocarbon (DuPont Viton® or Equivalent) Lower		
Max. Liquid Temperature	104°F (40°C)		

MOTOR DETAILS

Speed	60 Hz, 1750 RPM			
Motor Design	Inverter-Duty Rated, Air-Filled Enclosure, Squirrel Cage, Induction Start			
Motor Efficiency Rating	NEMA Premium Efficiency (IEC IE3)			
Insulation	Class H, Rated 356°F (180°C)			
Max. Submergence	65 Feet (20 Meters)			
Min. Submergence	1/2 Motor Covered			
Max. Starts per Hour	10			
Max. Rated Output Power	15 HP (11,2kW)	20 HP (14,9kW)	24 (17,9 Kw)	
Amp Draw @ Max. Rated Power: Full Load/ Locked Rotor NEMA CODE ()	208V/3P	46.8/416(L)	58.6/416(J)	
	230V/3P	42.4/376(L)	53/376 (J)	61.6/376(G)
	460V/3P	21.2/188(L)	26.5/188 (J)	30.8/188(G)
	575V/3P	17.0/150(L)	21.2/150 (J)	24.6/150(G)
Service Factor	1.15	1.15	1.15	
Efficiency: 100%/75%/50% Load	86%/87%/87%	93%/90%/90%	92%/92%/91%	
Power Factor: 100%/75%/50% Load	0.82/0.81/0.74	0.83/0.77/0.70	0.82/0.78/0.67	
Field Connection	Across-the-Line			
Moisture Sensor	Single Probe Monitoring Both Seal and Motor Chambers			
Thermal Overload	One Thermostat per Phase, Self-Resetting			

CABLE DETAILS

Power Cable	Voltage	230/460V	575V
	No. Cables/Conductors per	1/6	1/6
	Gauge	(3) 4 AWG PWR & (3) 8 AWG GND/GC	(3) 8 AWG PWR & (3) 10 AWG GND/GC
	Type/Material	GGC	GGC/CPE
Control Cable	Nominal Cable O.D.	1.19" (23,1 mm)	0.97" (19,0 mm)
	No. Cables/Conductors per	1/4	
	Gauge	14 AWG	
	Type/Material	SOOW/CPE	
Nominal Cable O.D.	0.61" (15,5 mm)		
Length	32 Feet (10 Meters) Standard, 164 Feet (50 Meters) Maximum		



GORMAN-RUPP PUMPS

www.grpumps.com

Specifications Subject to Change Without Notice

Printed in U.S.A.

Specification Data

SECTION 133, PAGE 1035.2

**MODELS SFSC4B
SLIDE RAIL VERSION
APPROXIMATE
DIMENSIONS and WEIGHTS**

NET WT: (pump only)
(comb. cable wt. per meter [3.2 ft.])
SHIPPING WT: (pump only)
CRATE SIZE:

670 LBS. [303 KG.]
3.4 LBS. [1,54 KG.]
710 LBS. [322,1 KG.]
25.1 CU. FT. [0,71 CU. M.]

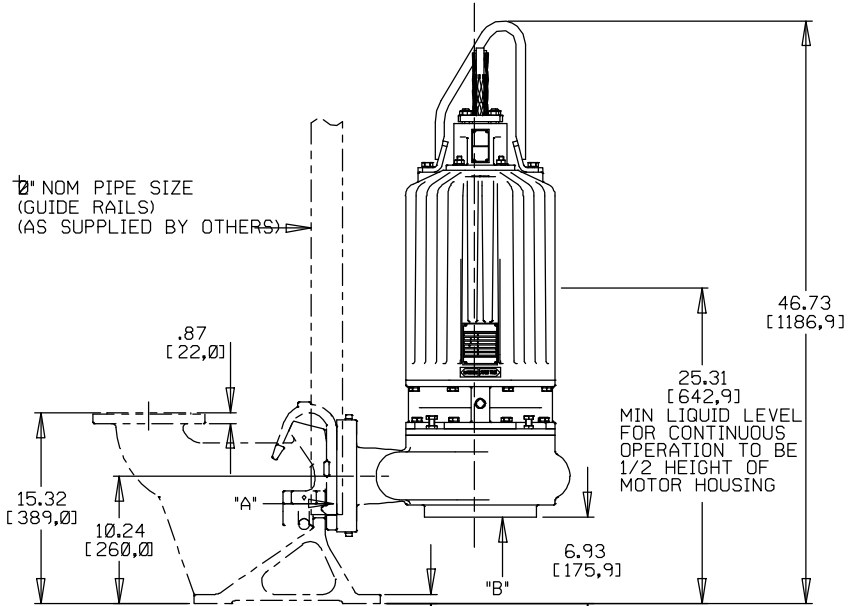
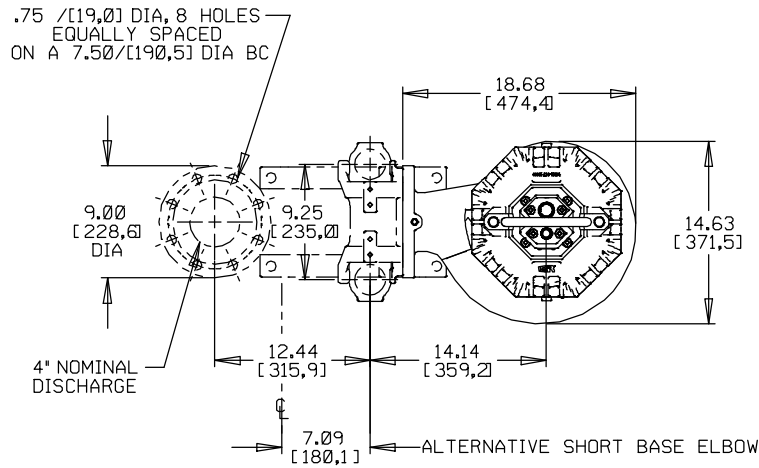

SHOWN WITH OPTIONAL
RAIL KIT AND BASE ELBOW

DIMENSIONS:
INCHES
[MILLIMETERS]

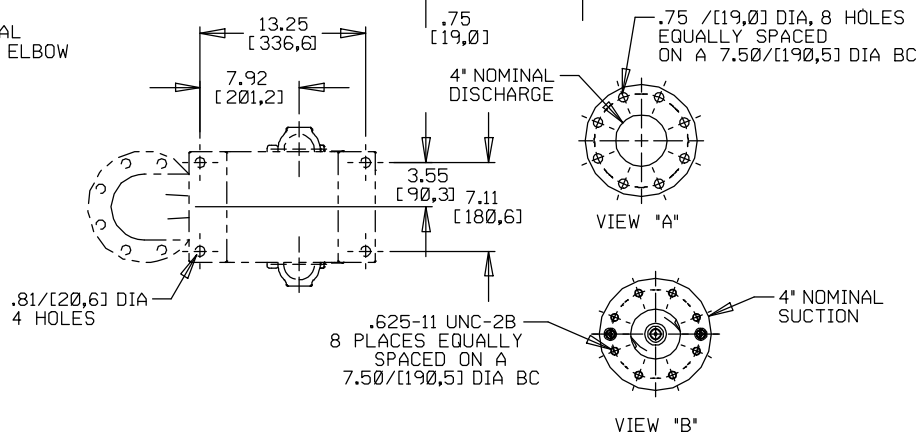

GORMAN-RUPP PUMPS

www.grpumps.com

Specifications Subject to Change Without Notice

Printed in U.S.A.

Specification Data	MODELS SFSC4B TRASH VERSION APPROXIMATE DIMENSIONS and WEIGHTS	NET WT: (pump only) 720 LBS. [326,6 KG.] (comb. cable wt. per meter [3.2 ft.]) 3.4 LBS. [1,54 KG.]	SHIPPING WT: (pump only) 760 LBS. [344,7 KG.] CRATE SIZE: 26.8 CU. FT. [0,76 CU. M.]
	SECTION 133, PAGE 1035.3		

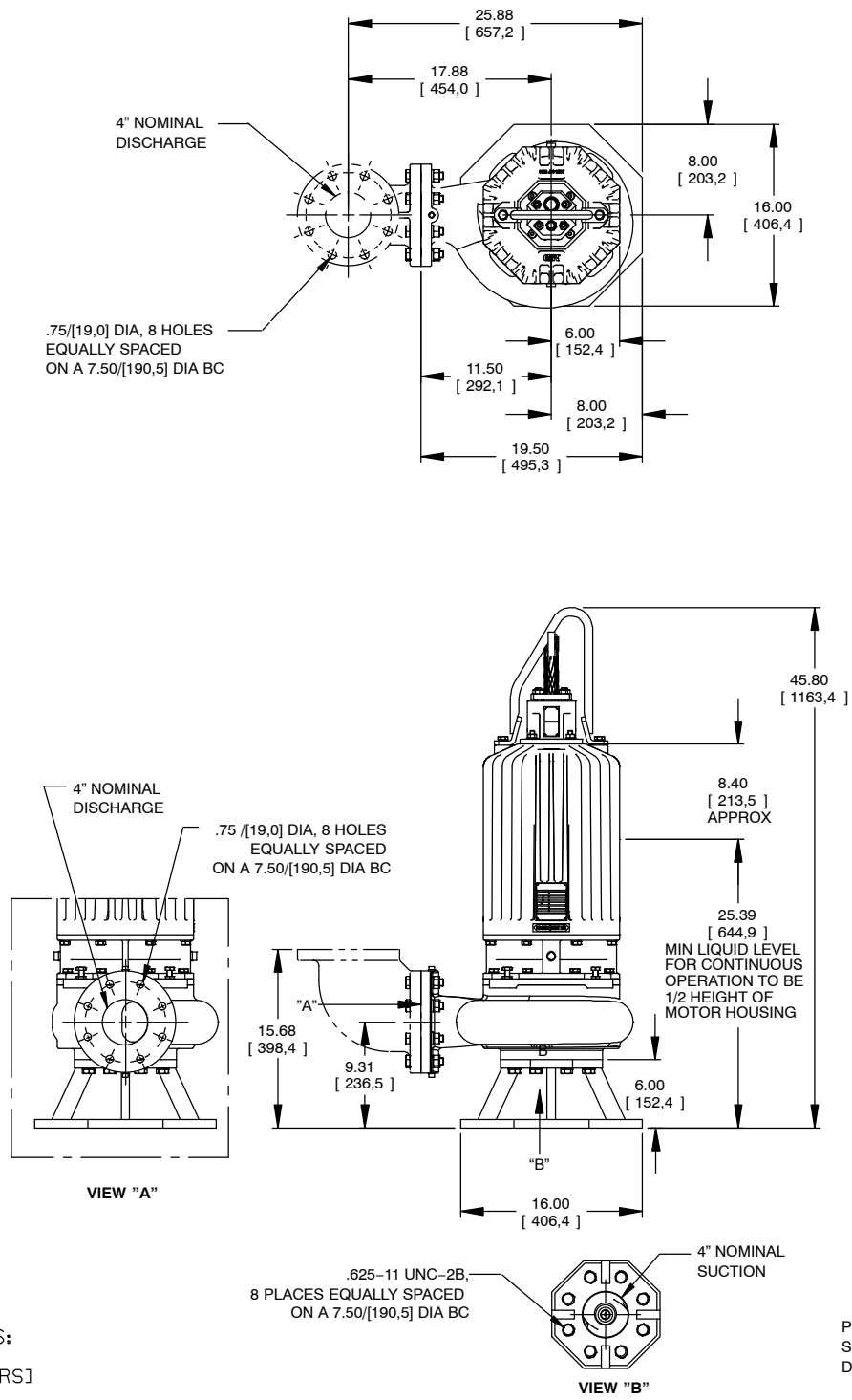

DIMENSIONS:
INCHES
[MILLIMETERS]

PUMP W/ TRASH STAND
SHOWN WITH OPTIONAL
DISCHARGE ELBOW



GORMAN-RUPP PUMPS

www.grpumps.com

Specifications Subject to Change Without Notice

Printed in U.S.A.

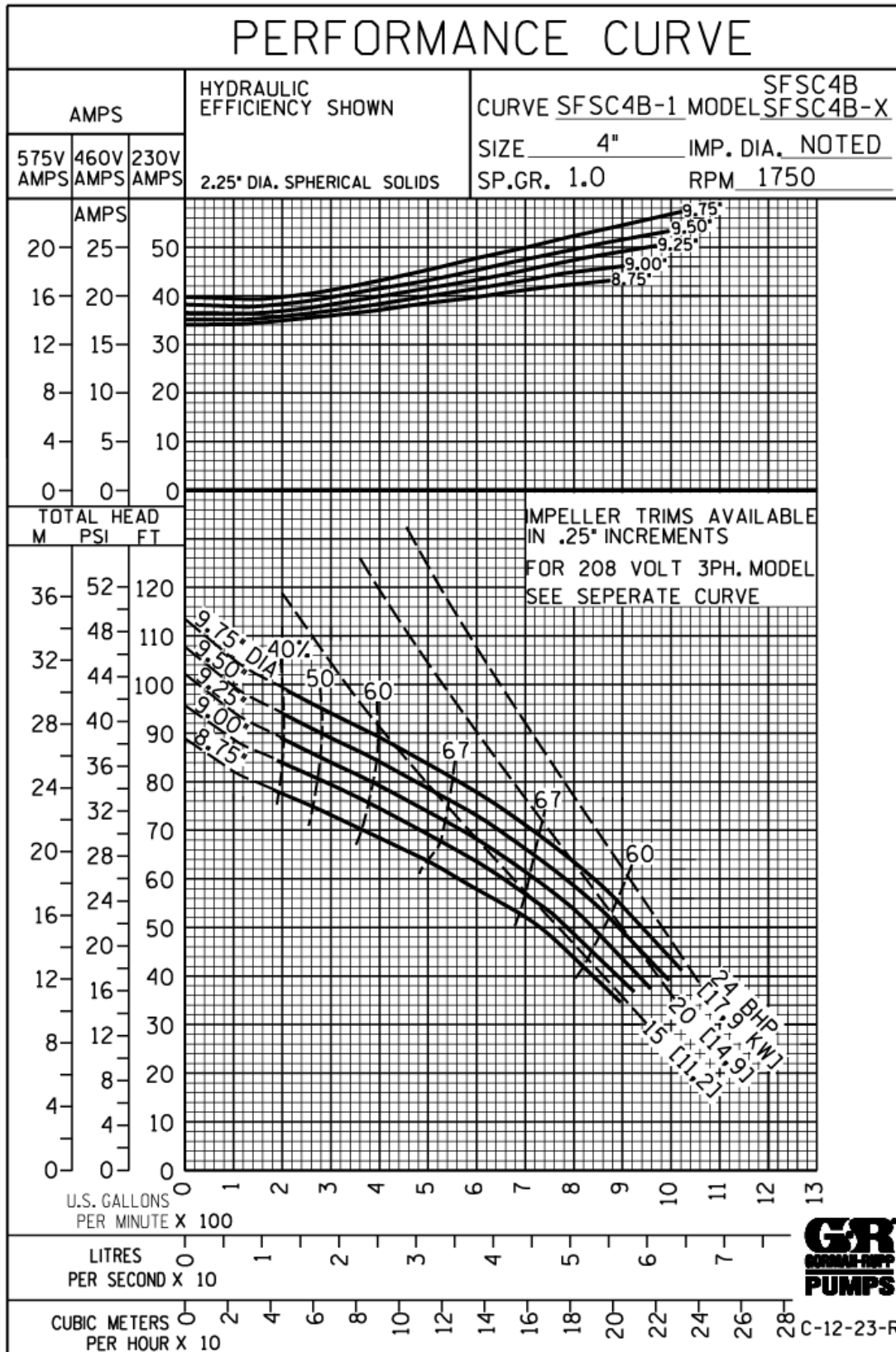

GORMAN-RUPP PUMPS

www.grpumps.com

Specifications Subject to Change Without Notice

Printed in U.S.A.