



1x4 LPASC

Low Profile Recessed Troffer



OVERVIEW	
Lumen Range (lm)	1950 - 8300
CCT (K)	3000, 3500, 4000, 5000
Wattage Range (W)	16- 63
Efficacy Range (LPW)	119 - 139
Weight lbs (kg)	14.5 (6.6)

QUICK LINKS

[Ordering Guide](#)[Performance](#)[Photometrics](#)[Dimensions](#)

FEATURES & SPECIFICATIONS

Construction

- Rigid housing is die-formed 20-gauge cold rolled steel for consistency and strength.
- End plates come equipped with integral NEC compliant earthquake clips.
- Ultra-slim < 4" luminaire height and lightweight design effectively target a broad range of plenum/wall spaces and allow for easy installations.
- Luminaire is proudly manufactured in the U.S.
- Luminaire is painted after fabrication following treatment with phosphate rust inhibitor. Finish coating of housing reflecting surfaces is with high-reflectance white (minimum 92%) polyester powder.

Optical System

- High transmission impact resistant diffuse acrylic radius lens eliminates bright spots from individual LED's and provides high vertical illumination and visual comfort.

Electrical

- High-performance programmable driver features overvoltage, under voltage, short-circuit and over temperature protection. Custom lumen and wattage packages available.
- 0-10 volt dimming (1% - 100%) standard.

- Standard Universal voltage (120-277 Vac) Input 50/60 Hz or optional High voltage (347Vac).
- L70 Calculated Life: >100k Hours (See Lumen Maintenance on Page 2)
- Total harmonic distortion: <20%
- Power factor: >.95
- Input power stays constant over life.
- Optional 120v-277v integral emergency battery pack is available to meet critical life-safety lighting requirements. A test switch/indicator button is installed in the housing for ease of maintenance.

Controls

- LSI AirLink™ controls featuring Lutron Clear Connect makes each luminaire controllable, creating a wireless communication with other AirLink™ control devices such as dimmers, switches, occupancy sensors and photocontrols. The integrated sensor is both a passive infrared motion detector and photocell.
- Step-level dimming option allows system to be switched to 50% power for compliance with common energy codes while maintaining fixture appearance.

Installation

- Luminaire installs by lifting it through grid ceiling and resting it on the T-bars.

- Luminaire installs onto standard 15/16" and narrow 9/16" T-grid ceiling systems.
- An accessory flange kit is available for installing into drywall or plaster.

Warranty

- LSI LED Fixtures carry a 5-year warranty.
- 1 Year warranty on optional Battery Back Up. Test regularly in accordance with local codes.

Listings

- Listed to UL 1598 and UL 8750 for 25°C Ambient applications.
- IC Rated.
- DesignLights Consortium® (DLC) Premium and/or standard qualified product. Not all versions of this product may be DLC qualified. Please check the DLC Qualified Products List at www.designlights.org/QPL to confirm which versions are qualified.
- RoHS Compliant.
- Suitable For Damp Locations.





1x4 LPASC Low Profile Recessed Troffer

ORDERING GUIDE

[Back to Quick Links](#)TYPICAL ORDER EXAMPLE: **LPASC14 LED 30L UNV SR 40 ALDCS EM10 U**

Family/Size	LED Gen	Lumen Package*	Voltage	Driver	Color Temperature	Controls	Options	Packaging
LPASC14 - (1x4)	LED	20L - 2000	UNV - 120-277V HV - 347V ¹	DIM1 - Dims to 1% (0-10 volt dimming) SR - Sensor Ready ^{1,3} SD50 - Step Dimming Driver to 50% ^{3,4}	30 - 3000K	BLANK - (No Controls) ALC - AirLink™ Controller	EM10- 10 watt Emergency Battery Backup FC1 - 6' 3/8" (3) #18 Leads (For use in Non-Dimming Applications) FC15D - 6' 3/8" (5) #18 Leads (For use in Dimming Applications) FC16DEM - 6' 3/8" (6) #18 Leads (For use in Dimming & EM Applications) 90C - 90 CRI ^{3,4}	U - Single Pack JP - Job Pack
		25L - 2500						
		30L - 3000						
		35L - 3500						
		45L - 4500						
		50L - 5000						
		55L - 5500						
		65L - 6500						
		70L - 7000						
		75L - 7500						
		80L - 8000						
		Custom Lumen Packages ⁵						
		50 - 5000K						

Accessory Ordering Information

Description	Order Number
Flange Kit 1x4	FK14

FOOTNOTES:

- 1 - Not available with AirLink.
- 2 - Available colors are White, Ivory and Light Almond (WH, IV, LA).
- 3 - Consult Factory for lead times.
- 4 - Consult factory for DLC qualification information.
- 5 - Custom lumen packages available, please consult factory. Values are within industry standard tolerances and not DLC listed.

AirLink™ Control Accessories Order as separate catalog number.

Wireless switches	Catalog number	Part Number	Wireless Occupancy Sensors	Part Number
On/Off & Raise Lower	ALWS 3B-(color)-KIT ²	6241032	Wireless 360° 400 ft², Ceiling Mount	624094
			Wireless 180° 3000 ft², Wall Mount	632617
Wireless Photocell controls	Catalog number	Part Number	Wireless 90° 2500 ft², Corner Mount	624096
On/Off & Dimming	ALCM-W-PC	624090	Wireless, Hallway 150 ft Length	632620
Commission Laser Kit				
(See Laser warnings)		634574		





1x4 LPASC Low Profile Recessed Troffer

PERFORMANCE

[Back to Quick Links](#)

DELIVERED LUMENS									
Lumen Package	3000K CCT		3500K CCT		4000K CCT		5000K CCT		Wattage
	Delivered Lumens	Efficacy	Delivered Lumens	Efficacy	Delivered Lumens	Efficacy	Delivered Lumens	Efficacy	
20L	1946	119.4	1963	120.4	2018	123.8	2152	132.0	16.3
25L	2435	120.0	2457	121.0	2526	124.4	2694	132.7	20.3
30L	2892	120.5	2918	121.6	3000	125.0	3199	133.3	24.0
35L	3381	119.9	3411	121.0	3507	124.4	3740	132.6	28.2
40L	3890	119.0	3925	120.0	4035	123.4	4303	131.6	32.7
45L	4358	125.6	4397	126.7	4520	130.3	4820	138.9	34.7
50L	4887	124.0	4931	125.1	5069	128.7	5406	137.2	39.4
55L	5373	123.5	5421	124.6	5573	128.1	5943	136.6	43.5
60L	5794	122.5	5846	123.6	6010	127.1	6409	135.5	47.3
65L	6284	122.3	6340	123.4	6518	126.8	6951	135.2	51.4
70L	6819	120.5	6880	121.6	7073	125.0	7543	133.3	56.6
75L	7280	119.7	7345	120.8	7551	124.2	8052	132.4	60.8
80L	7510	118.5	7578	119.5	7790	122.9	8307	131.0	63.4

*LED Chips are frequently updated therefore values are nominal.

ELECTRICAL DATA*							
Lumens	Watts	120V	208V	240V	277V	347V	
20L	16.3	0.136	0.078	0.068	0.059	0.047	
25L	20.3	0.169	0.098	0.085	0.073	0.059	
30L	24.0	0.200	0.115	0.100	0.087	0.069	
35L	28.2	0.235	0.136	0.118	0.102	0.081	
40L	32.7	0.273	0.157	0.136	0.118	0.094	
45L	34.7	0.289	0.167	0.145	0.125	0.100	
50L	39.4	0.328	0.189	0.164	0.142	0.114	
55L	43.5	0.363	0.209	0.181	0.157	0.125	
60L	47.3	0.394	0.227	0.197	0.171	0.136	
65L	51.4	0.428	0.247	0.214	0.186	0.148	
70L	56.6	0.472	0.272	0.236	0.204	0.163	
75L	60.8	0.507	0.292	0.253	0.219	0.175	
80L	63.4	0.528	0.305	0.264	0.229	0.183	

*Electrical data at 25C (77F). Actual wattage may differ by +/-10%.

RECOMMENDED LUMEN MAINTENANCE ¹					
Ambient Temp C	0 hrs. ²	25K hrs. ²	50K hrs. ³	75K hrs. ³	100K hrs. ³
25	100.00%	94.49%	91.48%	88.47%	85.56%

1 - Lumen maintenance values at 25°C are calculated per TM-21 based on LM-80 data and in-situ luminaire testing.

2 - In accordance with IESNA TM-21-11, Projected Values represent interpolated value based on time durations that are within six times (6X) the IESNA LM-80-08 total test duration (in hours) for the device under testing ((DUT) i.e. the packaged LED chip).

3 - In accordance with IESNA TM-21-11, Calculated Values represent time durations that exceed six times NA LM-80-08 total test duration (in hours) for the device under testing ((DUT) i.e. the packaged LED chip).





1x4 LPASC Low Profile Recessed Troffer

PHOTOMETRICS

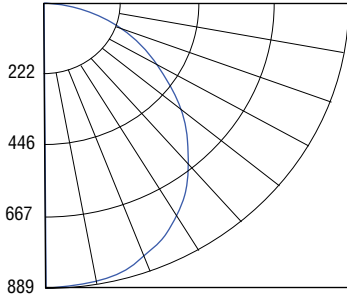
[Back to Quick Links](#)

LPASC14 LED 30L 40

Luminaire photometry has been conducted by a NVLAP accredited testing laboratory in accordance with IESNA LM-79-08. As specified by IESNA LM-79-08 the entire luminaire is tested as the source resulting in a luminaire efficiency of 100%.

See <http://www.lsi-industries.com/products/led-lighting-solutions.aspx> for detailed photometric data.

ZONAL LUMEN SUMMARY

Zone	Lumens	% Luminaire
0-20	327.6	10.8
0-30	712.9	23.5
0-40	1,199.4	39.6
0-60	2,242.9	74.0
0-80	2,945.6	97.2
0-90	3,030.7	100.0
10-90	2,947.5	97.3
20-40	871.7	28.8
20-50	1,403.4	46.3
40-70	1,468.7	48.5
60-80	702.7	23.2
70-80	277.5	9.2
80-90	85.1	2.8
90-180	0.0	0
0-180	3,030.7	100.0

PRODUCT DIMENSIONS

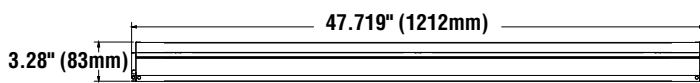
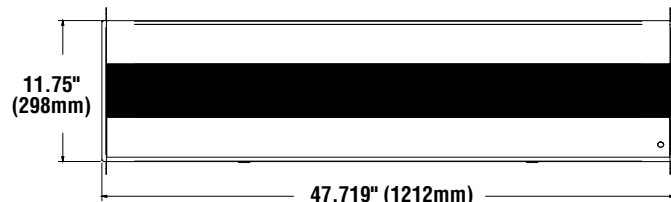
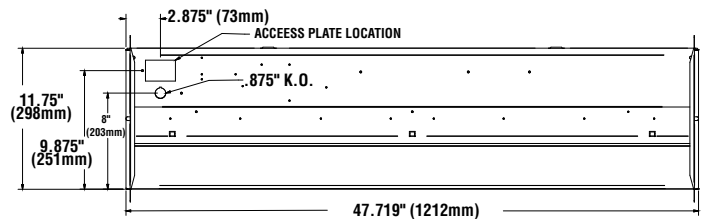
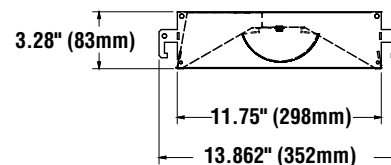
[Back to Quick Links](#)**SIDE VIEW****TOP VIEW****BACK VIEW****END VIEW**