



DISPENSERS



FUEL KITS



PUMPS



METERS



NOZZLE



FILTRATION

OCIO 2.0

FEATURES

- LOW/HIGH LEVEL ALARMS
- FLUID QUANTITY INDICATION
- FLUID HEIGHT INDICATION
- BUILT-IN DISPLAY
- COMPATIBLE WITH SSM 2.0 AND MCO 2.0

With its brand-new design, OCIO 2.0 is the upgraded version of the tank level indicator compatible with SSM 2.0 and MCO 2.0 systems. It requires a LAN or Wi-Fi connection to communicate with the software. It maintains all the performances of the standard OCIO. Thanks to its interchangeable probe, OCIO 2.0 is compatible with several fluids.

PERFORMANCE

UP TO
13 FT
HEIGHT
TANK

1%
FULL SCALE
ACCURACY

UP TO
164 FT
LENGTH
PROBE TUBE

UP TO
30 CST
VISCOSITY



OCIO

32 FT HOSE

BRASS PROBE

PACKAGING

PART #	WEIGHT		PACKAGING		
	KG	LBS	MM	INCH	PCS/BOX
FO0755230	2.2	4.8	300X410X100	11.8X16.1X3.9	1
FO0755240	2.2	4.8	300X410X100	11.8X16.1X3.9	1
FO0755250	2.2	4.8	300X410X100	11.8X16.1X3.9	1



FLUID
MONITORING

- A AIR
 A ANTIFREEZE
 D DEF
 B BIODIESEL
 D DIESEL
 F FOOD
 G GASOLINE
 G GREASE
 K KEROSENE
 O OIL
 W WATER
 W WINDSCREEN

CONNECTION

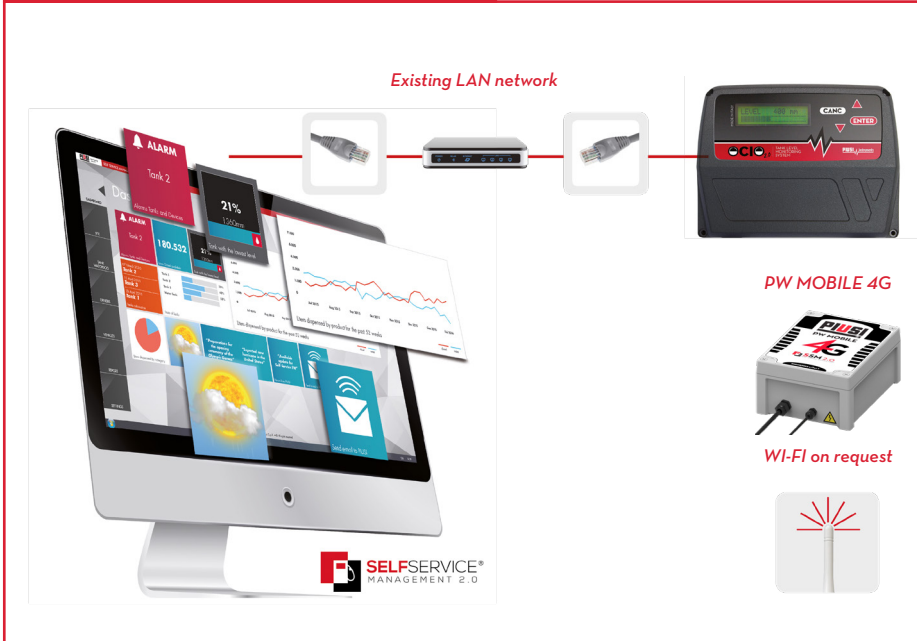

IN THE BOX

- OCIO UNIT
- PROBE
- 32 FT TUBE
- INSTRUCTION MANUAL

DETAILS

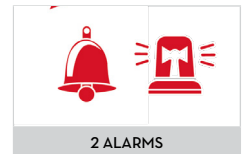

MATERIALS

- PROBE: BRASS
- TUBE: TECHNOLYMER

FUNCTIONING

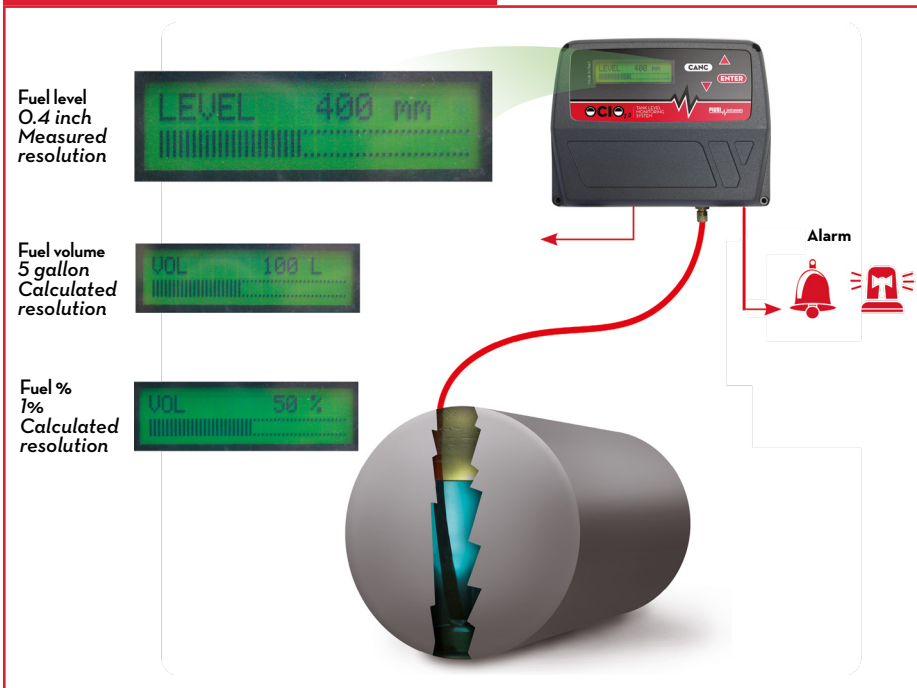

TECHNICAL DATA

PART #	DESCRIPTION	FLUIDS TYPE	VISCOSITY cSt	VOLTAGE		RS EXIT
				AC V./HZ	POWER WATT	
FO0755230	OCIO LEVEL INDICATOR 2.0 LAN (DIESEL)	A B D O W W	UP TO 30	120/60	20	REQUIRED
FO0755240	OCIO LEVEL INDICATOR 2.0 WIFI (DIESEL)	A B D O W W	UP TO 30	120/60	20	REQUIRED
FO0755250	OCIO LEVEL INDICATOR 2.0 RS-485 (DIESEL)	A B D O W W	UP TO 30	120/60	20	REQUIRED