



V20

115V & 230V (AC)

Fuel Transfer Pump

Bomba de transferencia de combustible

Pompe de transfert de carburant

20 GPM (76 L/min)

**Models: V20-115PO, V20-230PX, V20-115MD, V20-230MD,
V20-115MU, V20-230MU, V20-115AD, V20-230AD, V20-
115AU, V20-230AU, V20-115RD, V20-230RD
(PATENT-PENDING)**

Thank you for choosing Great Plains Industries as your preferred brand! Our team places innovation, precision, and care into every product made, providing you with the best total value. This manual contains critical product information.

Save these instructions and observe all safety information to prevent personal injury or property damage. See back cover for warranty and customer support details.

DO NOT RETURN THIS PRODUCT TO THE STORE!

Please contact Great Plains Industries, Inc. before returning any product. If you are missing parts, or experience problems with your installation, contact our Customer Support Department. We will be happy to assist you.

EN

¡Gracias por elegir Great Plains Industries como su marca preferida! Nuestro equipo pone innovación, precisión y cuidado en cada producto fabricado, proporcionándole el mejor valor total. Este manual contiene información crítica del producto. Guarde estas instrucciones y observe toda la información de seguridad para evitar lesiones personales o daños materiales. Consulte la contraportada para obtener detalles sobre la garantía y el soporte al cliente.

¡NO DEVUELVA ESTE PRODUCTO A LA TIENDA!

Comuníquese con Great Plains Industries, Inc. antes de devolver cualquier producto. Si le faltan piezas o experimenta problemas con su instalación, comuníquese con nuestro Departamento de atención al cliente. Estaremos encantados de ayudarle.

ES

Merci d'avoir choisi Great Plains Industries comme votre marque préférée! Notre équipe place l'innovation, la précision et le soin dans chaque produit fabriqué, vous offrant la meilleure valeur totale. Ce manuel contient des informations critiques sur le produit. Conservez ces instructions et respectez toutes les informations de sécurité pour éviter les blessures corporelles ou les dommages matériels.

Consultez la couverture arrière pour obtenir des détails sur la garantie et le support client.

NE PAS RENVOYER CE PRODUIT AU MAGASIN !

Veuillez contacter Great Plains Industries, Inc. avant de retourner un produit. S'il vous manque des pièces ou si vous rencontrez des problèmes avec votre installation, contactez notre service d'assistance à la clientèle. Nous serons heureux de vous aider.

FR

Call / Llamar / Appel: 800-835-0113 or 316-686-7361

Email: [gpsales@gpslains.com](mailto:gpisales@gpslains.com)

Website: gpi.net

SAVE / GUARDAR / CONSERVEZ

Model / Modelo / Modèle #: _____

Serial / Serie / Série #: _____

Date / Fecha / Date: _____

BEFORE YOU BEGIN

Fuel Compatibility Statement

- This fuel pump is designed, tested and approved for use with gasoline blends (up to E15), diesel fuel blends (up to B20) and kerosene. In addition, the PO/PX models are approved for use with Aviation Gasoline (AVGAS 100LL) and kerosene (Jet A). Please take all due precautions when handling these flammable liquids.
- Do not use this pump for dispensing any fluids other than those for which it was designed. To do so may damage the pumps components and will void the warranty.

Attention: Biodiesel blends have not yet been evaluated by any regulating agency

Power Source Requirements



- Pump models that include “115” are to be connected to 115V (ac); Do not attempt connection of any of these pumps to a (dc) power source. Do not attempt connection of any of these pumps to a 230V (ac) power source without reconfiguring the wiring in the junction box. (see pg.15)
- Pump models that include “230” are to be connected to 230V (ac); Do not attempt connection of any of these pumps to a (dc) power source. Do not attempt connection of any of these pumps to a 115V (ac) power source without reconfiguring the wiring in the junction box. (see pg.15)

Tools Needed



- Adjustable Wrench, Pipe Wrench, Pliers, Utility Knife, Wire Crimper/Stripper, and Metric Hex Wrenches (Hex Key).

CONTENTS



Model	Lockable Nozzle Holder	Modular Fitting & Hardware	18 FT Dispensing Hose	Nozzle
PO/PX	X	X	N/A	N/A
RD	N/A	X	N/A	N/A
MD	X	X	1”	Manual Diesel
MU	X	X	3/4”	Manual Unleaded
AD	X	X	1”	Automatic Diesel
AU	X	X	3/4”	Automatic Unleaded

UNPACKING

Shipping Damage Check



- After unpacking the unit, inspect carefully for any damage that may have occurred during transit. Check for loose, missing or damaged parts. Shipping damage claims must be filed with carrier. Review General Safety Instructions and all Caution, Warning, and Danger statements as shown.

GENERAL SAFETY INSTRUCTIONS

IMPORTANT: It is your responsibility to:

- Know and follow applicable national, state and local safety codes pertaining to installing and operating electrical equipment for use with flammable liquids.
- Know and follow all safety precautions when handling petroleum fuels.
- Ensure that all equipment operators have access to adequate instructions concerning safe operating and maintenance procedures.

Observe all safety precautions concerning safe handling of petroleum fuels

SYMBOLS



Description of imminent hazard and failure to avoid hazard will result in death.



Description of hazard and possible resulting injuries or death.



Description of hazard and possible resulting injuries.



This symbol indicates a general warning to the user. See additional specific warnings.



This symbol indicates electrical shock hazard. Follow proper installation and maintenance instructions in this manual.



This symbol indicates hot surface. Take care to avoid coming into contact with hot surface.



This symbol indicates automatic restart. Pump contains thermal protection which automatically shuts off motor before overheating. Pump will turn back on automatically after cooling. Turn switch OFF and wait 30 minutes to resume normal pumping. Disconnect power before any inspection or service.



Owner's manual must be read before using, inspecting, or servicing this product.



Disconnect power when product is unattended or in the case of a malfunction. Disconnect power before any inspection, servicing, or maintenance.



To prevent physical injury or property damage, observe precautions against fire or explosion when dispensing fuel. Do not operate the system in the presence of ignition sources such as, but not limited to: open flames, lighted cigarettes, running or hot engines, gas or electric heaters.



GENERAL SAFETY INSTRUCTIONS (CONTINUED)**SAFETY WARNINGS****▲ DANGER**

To prevent physical injury or property damage, observe precautions against fire or explosion when dispensing fuel. Do not operate the system in the presence of any source of ignition including running or hot engines, lighted tobacco products, gas or electric heaters, or any type of electronic device. A spark can ignite fuel vapors.

▲ DANGER

Observe precautions against electrical shock when operating the system. Serious or fatal shock can result from operating electrical equipment in damp or wet locations.

▲ DANGER

Observe precautions against electrical shock when servicing the pump. Always disconnect power before repairing or servicing. Never apply electrical power to the system when any of the cover plates are removed.

▲ WARNING

To ensure safe operation, all fuel transfer systems must be properly grounded. Proper grounding means a continuous metal-to-metal contact from one component to the next, including tank, tank mount, pump, meter, filter, hose and nozzle. Care should be taken to ensure proper grounding during initial installation and after any service or repair procedures. For your safety, please take a moment to review the warnings below.

▲ WARNING

Inspect external pump wiring regularly to make sure it is correctly attached to the battery. To avoid electrical shock, use extra care when connecting the pump to power.

▲ WARNING

Avoid prolonged skin contact with petroleum fuels. Use protective goggles, gloves and aprons in case of splashing or spills. Change saturated clothing and wash skin promptly with soap and water.

▲ WARNING

All wetted connections should be sealed with appropriate sealant, thread tape, O-rings, and securely fastened. Leaking fuel may cause the potential for fire and explosion.

▲ WARNING

PUMP MODELS THAT MAY BE USED IN AVIATION REFUELING (PO/PX MODELS) ARE NOT SUPPLIED WITH APPROPRIATE HOSE, NOZZLE, AND SUCTION PIPE. THESE ITEMS MUST MEET NFPA 407 GUIDELINES.

For ground-based refueling only. Do not use in or on the aircraft. For use with aviation gasoline (AVGAS 100LL) and kerosene grade (Jet A). User should consult NFPA 407 Standard for Aircraft Fuel Servicing for safety requirements during ground fuel servicing of aircraft using liquid petroleum fuels. This product has no actual or implied compliance with this standard.

▲ WARNING

This pump is provided with an internal auxiliary temperature-limiting device which automatically shuts off the motor before overheating. The pump will turn back on automatically after cooling if the switch is not in the off position. Turn the switch OFF and wait 30 minutes to resume normal operation.

▲ CAUTION

If using solvent to clean pump components or tank, observe the solvent manufacturer's recommendations for safe use and disposal.

SPECIFICATIONS

	PX	PO	RD	MD	AD	MU	AU	
Housing Material	Cast Iron							
Pump Rate*	20 GPM (76 L/min)							
Duty Cycle	Intermittent, 30 minute ON, 30 minute OFF							
Suction Lift*	Up to 15 ft. (4.5 m)							
Operating Temperature	-20 °F to 125 °F (-29 °C to 52 °C)							
XTS Operating Temperature	Extreme Temperature Series pumps are capable of operation down to -40 °F (-40 °C). Any pump operation below -20 °F (-29 °C) has not been evaluated by any regulating agency.							
Max. Surface Temperature	320 °F (160 °C)							
Operating Pressure	Up to 25 PSI (1.72 bar)							
Input*	115VAC 60Hz 230VAC 50/60Hz							
Current Draw*	115V AC 60Hz 5.5A 230V AC 60Hz 2.8A							
Motor*	1690 RPM, 1/2 hp							
Whole Pump Approval	UL 79							
Motor Approval	cULus Listed, Class I Div 1 IECEX/ATEX Zone 1	cULus Listed, Class I Div 1 Only						
Motor Protection	Thermal Breaker (Automatically Resets)							
Tank Adapter	2" BSPT	2 in. NPT						
Inlet	1" BSPP	1 in. NPT						
Outlet	1" BSPP	1 in. NPT						
Hose Type	N/A			Buna-N Electrically Conductive Discharge Hose with Static Wire				
Hose Size	N/A			1 in. x 18 ft. (5.5 m)		3/4 in. x 18 ft.		
Nozzle	N/A			1 in. Manual Diesel	1 in. Auto Diesel	3/4 in. Manual Unleaded	3/4 in. Auto Unleaded	

***NOTE:** 50Hz supply voltage will produce pump rate of 61L/min, suction lift of 3.9m, current draw of 4.3A, motor performance of 1395 RPM, and 4/10 HP.

SPECIFICATIONS (CONTINUED)**DIMENSIONS**

A. Pump Assy Width	8.26in. (20.98 cm)
B. Pump Assy Height	11.68 in. (29.67 cm)
C. Pump Assy Depth	14.08 in. (35.76 cm)

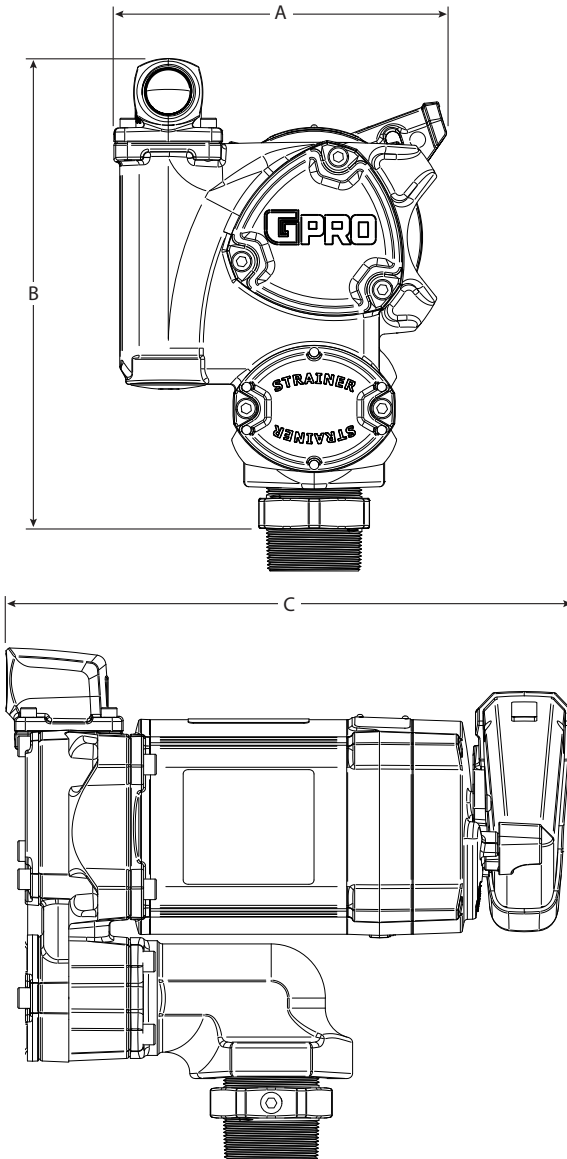
**Figure 1**

SPECIFICATIONS (CONTINUED)**SAFETY TESTING APPROVALS**

The V20 has been tested for compliance to the standards issues by Underwriters Laboratories. The pump utilizes a motor IM050 (or IM050X for PX pump models) that has been tested for compliance to the standards issues by Underwriters Laboratories. In addition to UL, the IM050X is compliant with IECEx, and ATEX.

V20

UL 79 (Tenth Edition) Standard for Power-Operated Pumps for Petroleum Dispensing Products.

**IM050 and IM050X**

UL 674 (Edition 5): Electric motors and generators for use in hazardous (classified) locations.

**IM050X****IEC Information**

Marking string: **Ex db IIA T4 Gb**
IECEx UL 23.0055X

Standards used:

IEC 60079-0 (Edition 7.0): Explosive Atmospheres – Part 0: Equipment - General requirements.

IEC 60079-1 (Edition 7.0): Explosive Atmospheres – Part 1: Equipment protected by flameproof enclosures “d”.

IECEx specific conditions of use:

1. Flameproof joints are not intended to be repaired.
2. The special fasteners used as securing bolts for the end bell are made of Class 12.9 type fasteners. The special fasteners used for electrical cover plate attachment are made of Class 12.9 type fasteners.

ATEX Information

Marking string: **CE**₂₈₀₉ **Ex** II 2 G Ex db IIA T4 Gb
UL 23 ATEX 3049X

Standards used:

EN IEC 60079-0: 2018

EN 60079-1: 2014

ATEX specific conditions of use:

1. Flameproof joints are not intended to be repaired.
2. The special fasteners used as securing bolts for the end bell are made of Class 12.9 type fasteners. The special fasteners used for electrical cover plate attachment are made of Class 12.9 type fasteners.

Declaration of Conformity

We declare, that the product:

Product Name: V20 Electric Fuel Pump Motor
Model Numbers: IM050X

Conforms with the requirements of the Directives below by compliance with the Standards subsequently listed:

1. Council Directive 2014/34/EU relating to equipment or protective systems intended for use in potentially explosive atmospheres,

EN IEC 60079-0:2017 Edition 7
EN 60079-1:2014 Edition 7

Supplementary Information:

Specific conditions of use:

- The flameproof joints are not intended to be repaired.
- The special fasteners used as securing bolts for the end bell are made of Class 12.9 type fasteners. The special fasteners used for electrical cover plate attachment are made of Class 12.9 typefasteners.

I the undersigned, hereby declare that the equipment specified above conforms to the above Directive(s) and Standard(s).

Signature:



Full Name:

Victor Lukic

Position:

President
Great Plains Industries, Inc.

Place:

Wichita, KS USA

Notified Body: UL International Demko A/S
Borupvang 5A
2750 Ballerup,
Denmark

Identification No: 0539

EU-Type Examination Certificate No: UL 23 ATEX 3049X REV. 0



5252 E. 36th St. N. Wichita, KS 67220-3205
316-686-7361 / f. 316-686-6746 / GPI.net

INSTALLATION INSTRUCTIONS

⚠ WARNING *Coverplates protect the operator from moving parts. Never operate the pump without coverplates in place. Never apply electric power to the pump without coverplates in place. Always disconnect power before repairing or servicing*

Mechanical Connections

NOTE: All threaded fuel connections must be sealed with thread tape or a pipe thread sealing compound approved for use with petroleum fuels and tightened securely to prevent leakage.

NOTE: This pump must be mounted on a vented tank.

NOTE: This pump is designed to mount directly to a standard 2 in. male pump tank mount adapter (included).

Install Tank Adapter and Suction Pipe

NOTE: For Aluminum Tank Installation - To prevent thread galling of aluminum fittings, always prepare the threads for assembly using an anti-seize compound such as Loctite® 567™, HERNON® Dripstop® 940 or equivalent.

1. Clean the tank interior of all dirt and foreign material.
2. For the suction pipe, a 1 in. steel pipe cut to length and threaded on one end may be used. Suction pipe should extend to within 3 inches of tank bottom.
3. Wrap the threaded end of suction pipe with three or four turns of thread tape (see Figure 2). Thread the suction pipe into the bottom of the adapter and hand tighten until snug.
4. Wrap the upper threaded end of the tank adapter with three or four turns of thread tape and insert suction pipe / tank adapter into threaded tank opening (see Figure 3). Using a wrench, tighten the adapter snugly into the fuel tank.

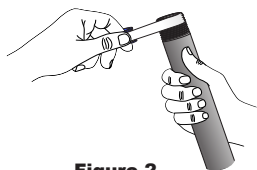

Figure 2

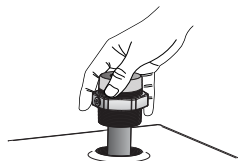

Figure 3

Install Pump on Tank

Using pliers, remove the plastic plug from inlet port on bottom of pump, then using a wrench, tighten the pump onto the adapter.

Install Nozzle Cover

NOTE: DO NOT install nozzle cover until after wiring is completed.

NOTE: RD versions do not include a Nozzle Cover. A bracket can be installed in its place to permanently keep the switch in the "ON" position so that the pump can be turned on/off at a remote dispense location (see Page 12).

Using a 4mm Hex wrench, install nozzle cover using (2) M6-1.0 x 14mm BHCS in lower hole (see Figure 4).

Install Outlet Adapter

1. Remove plastic plug from outlet port of pump.
2. Install #222 O-ring into outlet port. Make sure O-ring is seated properly.
3. Using a 5mm Hex wrench, install the (4) M6-1.0 x 20mm SHCS into the outlet adapter in desired direction on outlet port (see Figure 4).

INSTALLATION INSTRUCTIONS (CONTINUED)

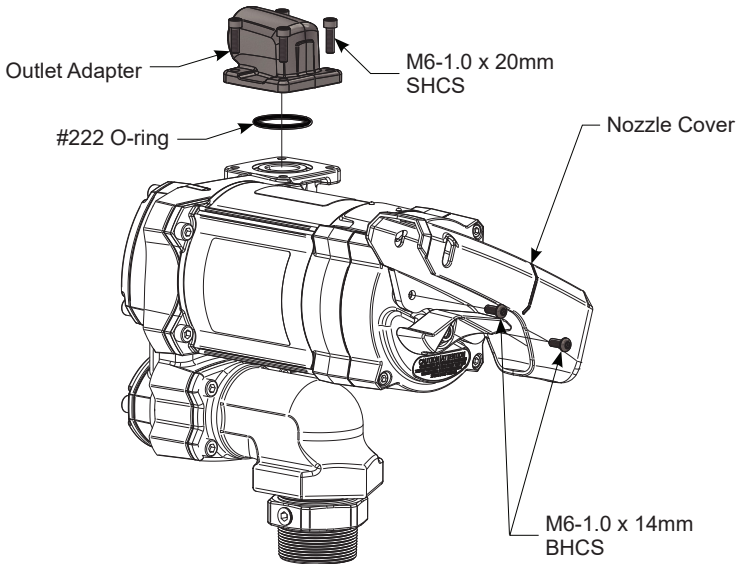

Figure 4

Install Hose and Nozzle

1. Wrap one end of the dispensing hose with three to four turns of thread tape and thread into outlet port. Tighten securely using an adjustable wrench.
2. Wrap opposite end of hose with three or four turns of thread tape and thread into nozzle. Tighten securely using an adjustable wrench.
3. Place the nozzle into the nozzle holder on the end of the pump motor housing. Note that the nozzle cannot be placed in the holder unless the pump switch is OFF (see Figure 8 and 9).

⚠ DANGER *If the pump is to be installed in a Hazardous (Classified) location, it must be installed by a licensed electrician and conform to National Fire Protection Association (NFPA) codes 30 and 70. You as the owner, are responsible for seeing that the installation and operation of your pump complies with NFPA codes as well as any applicable state and local codes. Rigid conduit must be used to install wiring. Note that the lead wires are factory-sealed isolating the motor from the junction box. Failure to follow these wiring instructions may result in death or serious injury from shock, fire or explosion.*

INSTALLATION INSTRUCTIONS (CONTINUED)

For Zone 1 or 2 (IECEX/ATEX)

Use a suitable Ex db cable gland during Zone 1 or 2 installations. Power cord or cable (not supplied) should be compliant with Clause No. 10.6.2 of IEC 60079-14. Conductors used for line voltage must have insulation rated at 105°C or above.

Remote Dispense and Switch Locking Bracket

Attention: RD pumps are only to be used with UL listed equipment/control devices. The equipment used must be suitable for the area classification it is being installed in. The RD remote dispenser pump incorporates an external switch lever lock that holds the pump switch in the "ON" position. The pump is typically shut off using a remote dispensing device "ON-OFF" mechanism.

Electrical Connections

Electrical wiring and connections must be made only by a licensed electrician in accordance with national, state and local electrical codes regarding Class I, Division 1, Group D locations. This includes but is not limited to the National Fire Protection Association (NFPA) Code 70, Article 501.15(A)(1). Other codes may apply.

Thread for the conduit connection at the pump junction box is 1/2 in. FNPT.

A 15-amp or 20-amp breaker is recommended.

Wiring Details

1. Remove electrical cover plate (see Figure 5). Install conduit and cable from supply power to pump junction box. Wiring must be in accordance with Class I, Division 1 requirements in the applicable national electrical code. Note that the lead wires are factory-sealed isolating the motor from the junction box.

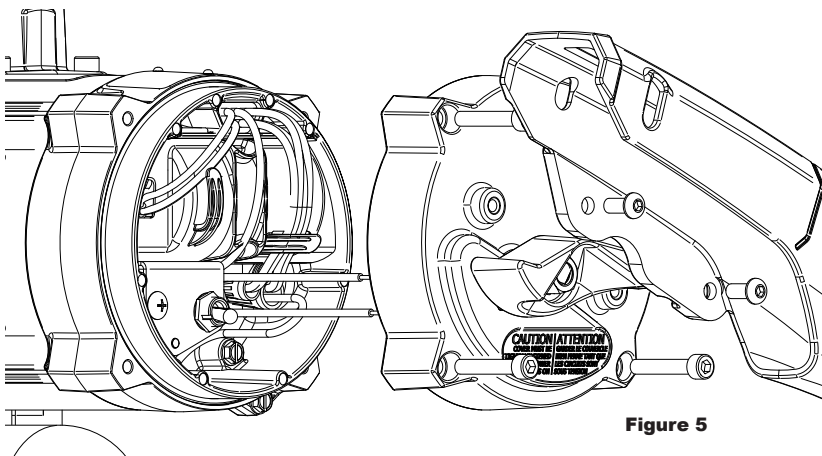

Figure 5

INSTALLATION INSTRUCTIONS (CONTINUED)

2. Attach ground wire using the green ground screw located inside the junction box (see Figure 6). The external bonding connection is only a supplemental bonding connection where local authorities permit or require such a connection.

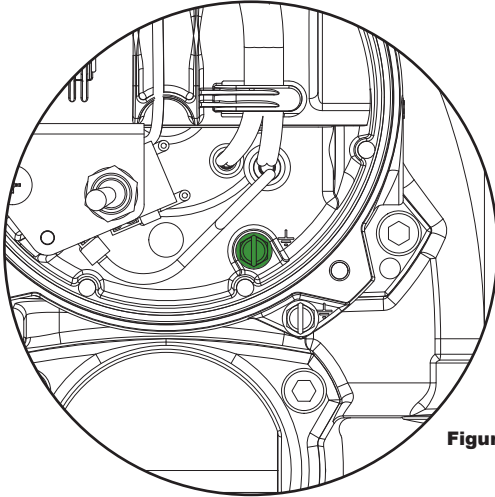

Figure 6

NOTE: An accessory AC control circuit can be used to operate a device such as a signal light or a solenoid operated valve. The “hot” AC lead should be tied into the large wire nut inside the junction box (see Figure 7), and the neutral lead should be tied with the neutral at the switch. Maximum amp draw on the control circuit should be limited to 1 amp.

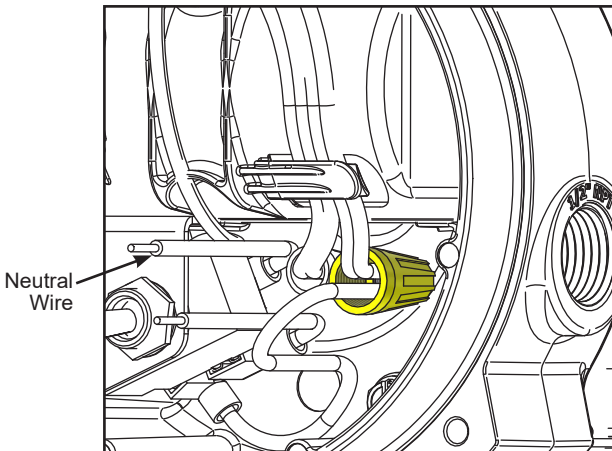
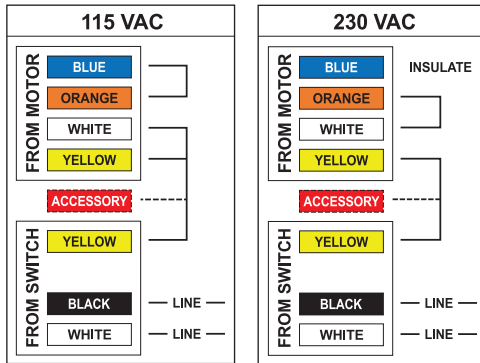

Figure 7

INSTALLATION INSTRUCTIONS (CONTINUED)

NOTE: The V20 is a dual voltage motor that can be converted between 115VAC and 230VAC if needed. For the motor to run in 115V configuration, couple the blue and orange motor leads together with a wire nut and then couple the white and yellow motor leads together along with the yellow lead from the switch with another wire nut. For the motor to run in 230V configuration, insulate the blue motor lead with a small wire nut, couple the orange and white motor lead with a wire nut and couple the yellow motor lead with the yellow lead from the switch with another wire nut. Refer to the wiring diagram.

NON-PX WIRING DIAGRAM



171902-01

Rev (-)

Figure 7a

PX WIRING DIAGRAM

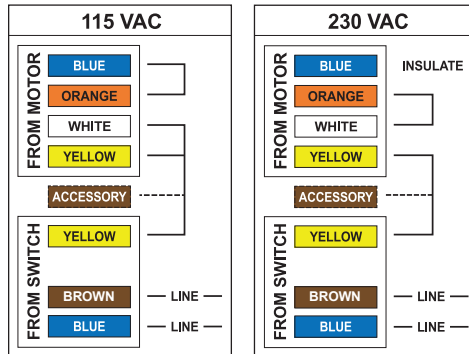

171902-02

Rev (-)

Figure 7b

- Match voltage, connect motor to power supply phases. (see Figures 7a/7b)
- Position wires inside the junction box and replace electrical cover. Install all four (4) screws.

OPERATION

IMPORTANT: Always follow safety precautions when operation this equipment. Review the safety instructions.

⚠ DANGER To prevent physical injury or property damage, observe precautions against fire or explosion when dispensing fuel. Do not operate the system in the presence of any source of ignition including running or hot engines, lighted tobacco products, gas or electric heaters, or any type of electronic device. A spark can ignite fuel vapors.

⚠ CAUTION Before each use, repair leaks around seals or connections. Make sure hoses are in good condition and connections are tight. If damaged, replace hoses before use.

NOTE: Make sure the work area is dry

⚠ WARNING Make sure the pump is properly grounded. Repair any corroded or damaged wiring before use.

NOTE: Ensure the tank contains enough fuel

IMPORTANT: Make sure the fuel is not contaminated with debris. Tighten loose tank lids regularly.

Dispensing Fuel

Remove the nozzle from holder and insert into receiving tank. Turn the pump on by pushing the switch lever up. Squeeze the handle to start fuel flow. When done, release the nozzle handle, turn the pump off, and return the nozzle to its holder.

IMPORTANT: This pump is designed to be self-priming. If fuel is not delivered within 15 to 20 seconds, turn the pump off and refer to priming information in the Troubleshooting Guide. (see pg. 18)

⚠ CAUTION An automatic bypass valve prevents pressure build up when the pump is on with the nozzle closed. To avoid pump damage, do not run the pump more than 10 minutes with the nozzle closed. Leaving the pump on with the nozzle closed for more than 10 minutes can damage the pump components and will void the warranty.

⚠ CAUTION Never leave the pump running without fluid. Dry running can damage the pump components, and will void the warranty.

IMPORTANT: This is an intermittent duty pump, after running the pump for a maximum of 30 minutes, allow it to cool for 30 minutes.

IMPORTANT: The motor is provided with an internal temperature-limiting device. Excessive motor heat will trip the device and will only reset after the motor has cooled. If the device trips, turn the switch OFF and let the pump cool for 30 min. Turn the switch ON again when ready to operate. If the device trips again before the end of the duty cycle, see the troubleshooting guide.

⚠ CAUTION Always turn the pump off if the temperature-limiting device trips. If left on, the pump will automatically reset when cool and start pumping.

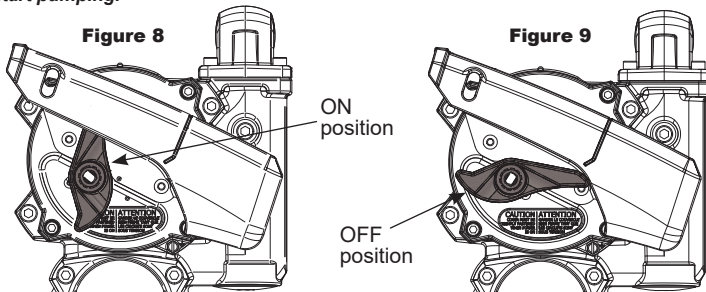

MAINTENANCE

NOTE: This pump is designed for minimum maintenance. The motor bearings are self-lubricating. Inspect the pump and components regularly for fuel leaks and make sure the hose and power cord are in good condition. If damaged, replace before use. Keep the pump exterior clean to help identify leaks.

IMPORTANT: Do not use this pump for water, chemicals or herbicides. Dispensing any fluid other than those listed in this manual (see BEFORE YOU BEGIN: Fueling Compatibility Statement at front of the owner's manual) may damage the pump. Use of the pump with unauthorized fluids will void the warranty.

Clean or Replace Check valve / Strainer

1. Turn the pump off and disconnect from power. Using 6mm hex wrench, remove the strainer access cover, O-ring, and check valve/strainer assembly and inspect for damage or clogs (see Figure 10). Clean the strainer with a soft-bristled brush and solvent. If the strainer is very dirty, compressed air may be used. If damaged, replace the check valve/strainer assembly.
2. Clean the strainer access cover and O-ring. Coat the O-ring lightly with grease. Reinstall the check valve/strainer, O-ring and strainer access cover. Ensure the O-ring is properly seated and tighten securely.

NOTE: Insert a flat tip screwdriver into the slot on the inside of the filter to pry it out of the cavity. (see Figure 10a)

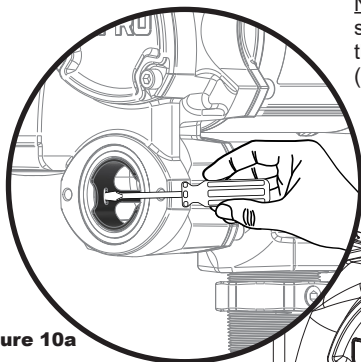

Figure 10a

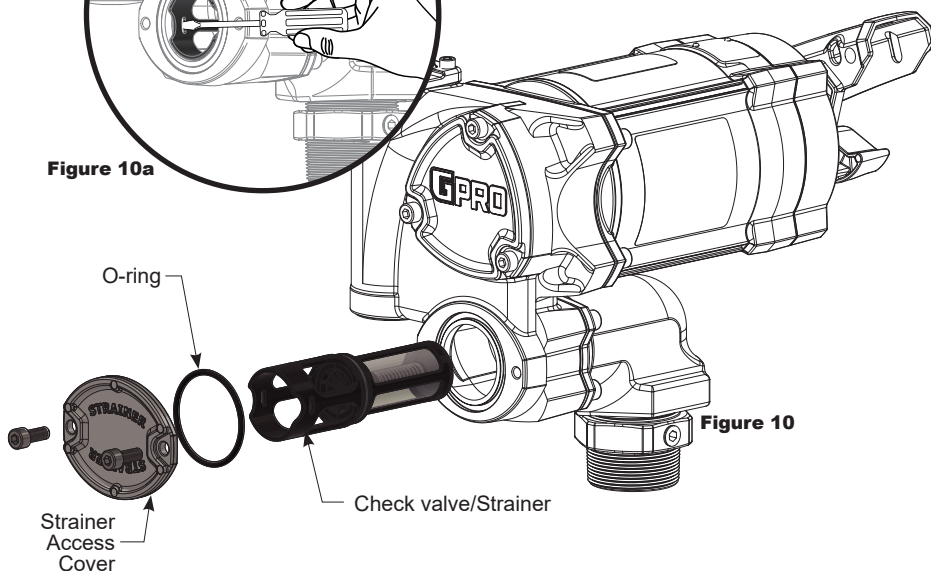

Figure 10

Repair

This motor has a replicable switch and capacitor; kits are available in the event of a failure. To replace these components, first turn off the pump and disconnect from power. Then, disassemble the nozzle hanger and junction cover as shown previously assembled from figures 4 and 5 on pg. 11 and 12. Follow the instructions provided with the kit to replace the failed component(s). Reassemble the cover and hanger and reconnect power. Before transferring fuel with the pump, verify that the motor does turn on and that the pump is properly running in bypass; if this is the case, the pump is ready for standard operation again.

For more information about replaceable pump components and troubleshooting, refer to the QR code on page 18.

Taking out of service and dismantling

To remove the pump, disconnect the power and reverse installation steps from page 14 to 10 in this manual.

MAINTENANCE/ MANTENIMIENTO/ ENTRETIEN

Scan the QR code below for more maintenance, troubleshooting, and repair resources.

EN

Escanee el código QR a continuación para obtener más recursos de mantenimiento, solución de problemas y reparación.

ES

Scannez le code QR ci-dessous pour accéder à des ressources supplémentaires sur la maintenance, le dépannage et la réparation.

FR**V20-115****V20-230**



Limited Warranty Policy

Great Plains Industries, Inc. (GPI) hereby provides a limited warranty against defects in material and workmanship on all products manufactured by GPI. The warranty period shall begin on the date of purchase confirmed with the original purchase receipt or, if not available, the date of manufacture. Manufacturer's sole obligation under the following warranties will be limited to either, at Manufacturer's option, replacing or repairing defective goods. If the product is no longer available, replacement may be made with a similar product of equal or greater value. Buyer's exclusive remedy for breach of any such warranties will be enforcement of such obligations of Manufacturer. The warranty shall extend to the purchaser of this product and to any person to whom such product is transferred during the warranty period.

Warranty shall not apply if:

The product has been subjected to neglect, misuse, abuse or damage or has been installed or operated other than in accordance with the manufacturer's operating instructions or the product has been altered or modified outside the warrantor's duly appointed representative.

Product components considered wear items, i.e. vanes, etc., are NOT included within the scope of this warranty.

Charges for shipping and insuring packages to GPI are the customer's responsibility. GPI will ship the warranted product back to the customer via ground shipping free of charge for shipments within the United States. International shipping charges and customs fees to and from GPI are the customer's responsibility.

GREAT PLAINS INDUSTRIES, INC., EXCLUDES LIABILITY UNDER THIS WARRANTY FOR DIRECT, INDIRECT, INCIDENTAL AND CONSEQUENTIAL DAMAGES INCURRED IN THE USE OR LOSS OF USE OF THE PRODUCT WARRANTED HEREUNDER.

THE COMPANY HEREWITH EXPRESSLY DISCLAIMS ANY WARRANTY OF MERCHANTABILITY OR FITNESS FOR ANY PARTICULAR PURPOSE OTHER THAN FOR WHICH IT WAS DESIGNED.

THIS WARRANTY GIVES YOU SPECIFIC RIGHTS AND YOU MAY ALSO HAVE OTHER RIGHTS WHICH VARY FROM U.S. STATE TO U.S. STATE.





In compliance with MAGNUSON MOSS CONSUMER WARRANTY ACT - PART 702 (governs the resale availability of the warranty terms)

To obtain warranty service contact the GPI Product Support Department:

316-686-7361 or 800-835-0113

GPI will guide you through a product troubleshooting process to determine the appropriate corrective actions.

The following respective warranty periods apply:

	<p>FIVE-YEAR WARRANTY applies to the following product families:</p> <p>GPRO® Fluid Transfer Pumps: PRO20-115, PRO20-230, V25-012, V25-024, PR035-115</p> <p>GPRO® Remote Dispensers: QM240-RD, QM150-RD</p> <p>GPRO® Fuel Meters: QM40</p> <p>GPI® Fuel Meters: M30</p>
	<p>TWO-YEAR WARRANTY applies to the following product families:</p> <p>GPI® Fluid Transfer Pumps: G8P, EZ8, M-150S, M-180S, M-240S, G20-012*, M-1115S, P-200, PA-200, P-120H, P-200H, PA-120H, PA-200H, HP-100, HP-90, DP-20, RP-10</p> <p>GPI® Fluid Meters: 01A, 01N, 03A, 03N, FM-300H, LM51DN, LM-300</p>
	<p>ONE-YEAR WARRANTY applies to the following products:</p> <p>GPI® Oil Transfer Pumps: L 5016, L 5116, L 5132</p>
	<p>90-DAY WARRANTY applies to the following products:</p> <p>GPI® Fluid Transfer Hand Pumps: RP-5, BP-12, CP-5, LP-50</p> <p>90-DAY WARRANTY applies to Spare Parts, Kits and Accessories including Nozzles*, Hoses, Swivels, Vent Caps, Filter Adapters, etc.</p> <p>90-DAY WARRANTY applies to Factory Repairs from repair date or the balance of the original warranty whichever is longer.</p>

**Extended warranty coverage available on select products. Requires registration of product with manufacturer. Visit gpi.net/product-registration/*



COMPANY HEADQUARTERS:
5252 East 36th Street North
Wichita, KS, USA 67220-3205

LEARN MORE: GPIpumps.com

Revision Date: June 29, 2021
CORP-1083 Rev B_Limited Warranty Policy